

THE TSE CAMPAIGN
2016 - 2020

Toulouse Talent - Global Impact





We owe our reputation to teamwork

Jean TIROLE
TSE Chairman,
Nobel Prize
for Economics, 2014

SUMMARY

- p.5 • Our vision
- p.7 • Our talents
- p.10 • Key figures
- p.12 • Our future
- p.16 • Our governors
- p.18 • Your support

TSE experts created an amazing place for young researchers.

Susan ATHEY
Professor of Economics
Stanford University



TSE is one of the best departments in the world.

Olivier BLANCHARD
Peterson Institute, MIT
& former IMF
Chief Economist



TSE is undoubtedly one of the foremost centres of research and teaching in the world today.

Amartya SEN
1998 Nobel Prize Laureate
Harvard University

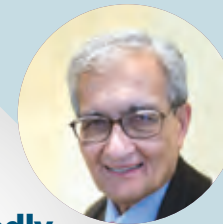

TSE has become a world-class research and teaching institution.

Eric MASKIN
2007 Nobel Prize Laureate
Harvard University



Join us in taking TSE even further: be part of the Toulouse Talent - Global Impact campaign.

Ulrich HEGE
TSE Director





OUR VISION

Economics can be a force for good in the world

Jean-Jacques LAFFONT

TSE founder, 1947-2004

In 1979 Jean-Jacques Laffont, world-class economist, returned to his hometown Toulouse from the USA. Visionary and entrepreneurial as he was, his dream was to combine the best of his different worlds to create a new model in France: an internationally renowned school of economics within a public university.

As Jean-Jacques used to say, *“Toulouse, c’est mon Amérique à moi”*. And so he gathered around him a strong group of like-minded colleagues committed to academic excellence, all determined for economics to have a real impact on society and everyday lives.

These so-called “*économistes de Toulouse*” steadily laid the foundations for what, 30 years later, has become Toulouse School of Economics, a thriving world-renowned center for research in economics chaired by Nobel-prize laureate Jean Tirole.

TSE strives to:

- ▶ provide solutions to today’s key economic and social issues
- ▶ promote excellence in research & higher education
- ▶ encourage pioneering interdisciplinary research
- ▶ connect research to policy, in France, Europe and worldwide
- ▶ implement highest international standards in its own governance





OUR TALENTS

A world-class research center in economics, connected to policy

The award of the Nobel Prize in Economics to Jean Tirole in 2014 came as a great recognition for TSE's achievements in its relatively short lifetime. Many other accomplishments make us proud, including a record-breaking number of European Research Council grants, top publications, high rankings and impactful recruitments.

TSE has always fostered an academic environment that nurtures a diverse range of international talent and expertise. We pride ourselves on attracting the best and the brightest to Toulouse from leading US and European institutions.

While TSE's unique atmosphere is hard to define, there is a palpable sense of a "TSE-style economics". Based on a broad range of academic interests and a deep sense of curiosity, open mindedness and an engrained culture of collaborative work, our approach is coupled with an appetite for tackling real-world problems and generating deployable policy solutions.



“ TSE is one of the very top economics faculties, incredibly strong in mechanism and market design. ”

Preston MCAFEE
Microsoft Chief Economist



“ In Toulouse, theory is done in a way that's relevant to all questions in the world, and that's wonderful. ”

Abhijit BANERJEE
MIT Professor



OUR TALENTS

An international graduate program

Our competitive international higher education programs within the University of Toulouse pioneer a novel approach to higher education in France.

While the core focus is economics, our courses are multidisciplinary and concentrate on the role that data and quantitative techniques play in decision-making in firms, institutions or states.

Mathematical modelling helps develop rigorous reasoning in complex situations and statistical and quantitative methods help to assess the impact of strategy changes and policy reforms.

In sum, our research-oriented courses train our students to master and adapt recent theories and techniques to solve the real-world challenges of their future employers.



“At TSE, students get the methodology and the tools to face a world that is getting more and more complex.”

Alexia LEE GONZALEZ FANFALONE
TSE PhD student



“Several former TSE students have joined us and their analytical capabilities are a clear asset.”

Fabrice BRÉGIER
Airbus CEO



OUR TALENTS

A pioneering interdisciplinary institute

In 2011 we launched the Institute for Advanced Study in Toulouse, IAST. Innovation in approaches and methods is engrained in our culture, as is the quantitative / empirical mix. IAST is a powerful example of this innovation at work. The scientific program involves nine social and behavioral sciences : anthropology, biology, economics, history, law, philosophy, political science, psychology and sociology. This is a unified scientific project whose aim is to study the behavioral of human beings as evolved biological organisms who live in groups, form networks and coalitions, are governed by formal institutions and informal norms, produce and exchange scarce resources and are inspired by ideals and beliefs.

Over its five years of existence, the IAST has made the transition from being a wholly unknown start-up to being a credible research institute with a growing international reputation and a novel way of working.



“IAST has become a major international research center, bringing together a quite extraordinary array of scholars in the equally extraordinary setting of Toulouse.”

Ian MORRIS
Professor of History, Stanford



“It is when we consider the deepest questions about human nature and society that we recognize the important role of IAST.”

Mahzarin R. BANAJI
Professor of Psychology, Harvard

KEY FIGURES & EXPERTISE



FINANCIAL
REGULATION



CLIMATE
CHANGE

2nd
best research
center in
micro
economics
(RePEc)

200
public debate
contributions
per year

2
Laboratories of
excellence

350
conferences and
seminars
per year

90
nationalities

40
research
partnerships



NETWORK INDUSTRY
REGULATION



Top 10
research center
in economics in
the world
(RePEc)

*7 ERC "starting" grants and
8 ERC "advanced" grants



PAYMENT
SYSTEMS



COMPETITION
LAW

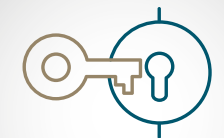

INTELLECTUAL
PROPERTY

2400
students

75
international
academic PhD
placements in
5 years

25
years of connecting
research to the
corporate
world

180
researchers



TWO-SIDED
MARKETS

3rd
beneficiary in
Europe of EU
support to economic
excellence*

300
international
visiting scientists
per year



OUR FUTURE

Toulouse Talent - Global Impact

Investing in Toulouse today means investing in a thriving economic hub and a city of knowledge. Already heralded as the world's capital of aeronautics, the "pink city" is also a hub for cancer research, home to the Hyperloop research center, and an incubator for digital talent. Attracting more and more international talent, Toulouse is securing its reputation as a prime location for science, investment, innovation, advanced engineering, and of course, quality of life. A city with growing global impact.

TSE is proud to contribute to Toulouse's reputation. To sustain and expand our collective ambitions, we must continue to provide the best conditions for fostering distinctive innovation.

We have hence launched our Toulouse Talent - Global Impact campaign with the aim of raising €50M.

Toulouse Talent - Global Impact has three main priorities:

- 1 / Solving key economic and social issues
- 2 / Educating the brightest future talent
- 3 / Offering an exciting location to foster innovation



OUR FUTURE

Solving key economic and social issues - €37M

Our goal is to encourage sustained multidisciplinary dialogue among researchers. While economics will always remain at the core of our activity, fascinating and often unexpected synergies emerge from an interdisciplinary approach, which is increasingly recognized as the future of top-flight academic endeavor.

But we need more.

- More **endowed chairs** and **visiting professorships** to retain existing talent and attract new and exciting ones.
- More global debate-fueled **focus centers**, chairs and institutes to support agendas as well as people.
- More **interdisciplinary programs** supporting the appointment of senior scholars.
- More **research projects** on wide-reaching themes such as health, infrastructure, migration, religion and the ageing of populations.

Key TSE research areas currently in need of your support:

- 1 / Climate change and energy
- 2 / Health behavior
- 3 / Sustainable finance



OUR FUTURE

Educating young talent - € 8M

Educating tomorrow's top economists is key to our future footprint. Today's students are tomorrow's ambassadors, essential for carrying TSE's vision far and wide. This is therefore our second campaign priority.

We will fund a range of internationally competitive scholarships and boost our overall educational package, focused on careers and designed to the highest international standards, attracting the very best students from all over the world.

The resources raised will enable not only the training of talented individuals at doctoral and postdoctoral levels, but also the funding of scholarships to attract the brightest undergraduate students coming from all corners of the world.

You can help us offer:

- 1 / Undergraduate & graduate scholarships
- 2 / Postdoctoral fellowships
- 3 / Tailor-made career support services

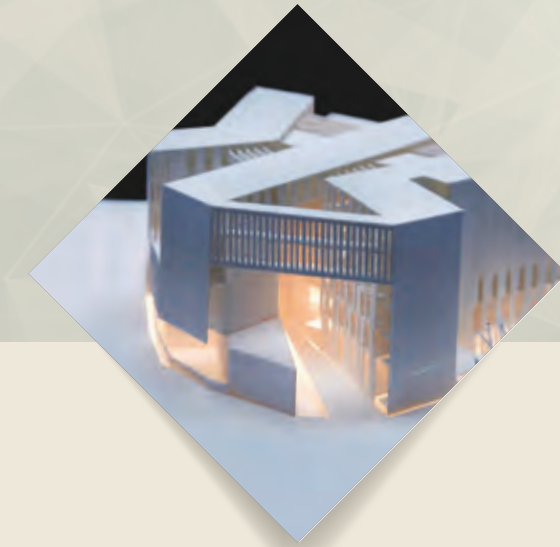

OUR FUTURE

Offering an exciting location to foster innovation - € 5M

In 2019 a brand new building will host TSE, a purpose-built *chef d'oeuvre* designed by internationally-renowned Irish architects Grafton and located on the university campus in the historic center of Toulouse.

While funding has already been secured for the building itself, TSE needs to raise funds to provide faculty and students with the best work environment possible, making TSE an exciting, cutting-edge place to work, think and learn, with the best equipment and environment.

Naming opportunities will be available in the new building, from amphitheatres to experimental laboratories and outreach areas.

Thanks to your support we will be able to provide our faculty with:

- 1 / State-of-the-art digital facilities
- 2 / Purpose-built behavioural experiment laboratories
- 3 / Public outreach areas mixing art, culture and science

TSE SCIENTIFIC COUNCIL

Philippe AGHION
Collège de France



Tim BESLEY
LSE



Richard BLUNDELL
UCL

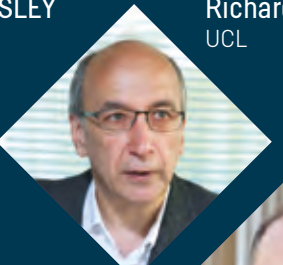

Armin FALK
University of Bonn



Jean-Marc ROBIN
SciencesPo



Drew FUDENBERG
MIT

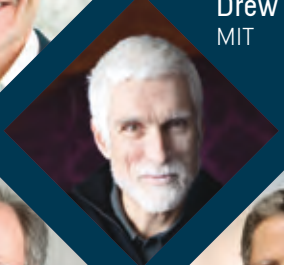

Eric MASKIN
Harvard



Tom SARGENT
New-York University



Rachel GRIFFITH
University of Manchester



Roger MYERSON
University of Chicago



Ariel PAKES
Harvard



Amartya SEN
Harvard



Rafael REPULLO
CEMFI, Madrid



Guido TABELLINI
Bocconi University



Antoinette SHOAR
MIT



IAST SCIENTIFIC COUNCIL

Mahzarin BANAJI
Harvard University



Rob BOYD
Arizona State University



Brandice CANES-WRONE
Princeton University



Marion FOURCADE
Berkeley University



Sergey GAVRILETS
University of Tennessee



Dora COSTA
UCLA

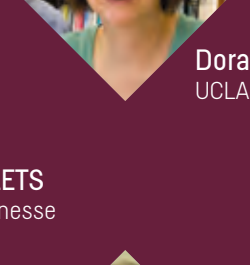

Elizabeth GERBER
University of Michigan



Gerard HERTIG
ETH Zurich



Cecilia HEYES
Oxford



Louis KAPLOW
Harvard Law School

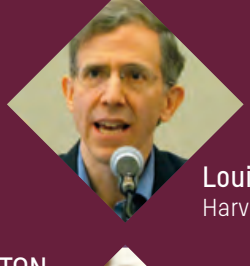

Hanna KOKKO
University of Zurich

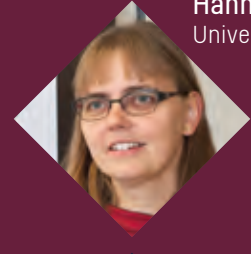

Rachel E. KRANTON
Duke University

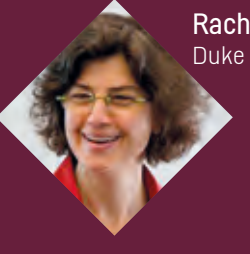

Benoit MONIN
Stanford University



Joel MOKYR
Northwestern



Ian MORRIS
Stanford University



Muriel NIEDERLE
Stanford University



David PAPINEAU
Kings College London



Drazen PRELEC
MIT



Howard ROSENTHAL
NYU



Thomas ROMER
Princeton



Lawrence ROTHENBERG
University of Rochester



Alan SCHWARTZ
Yale Law School



Tom SNIJDERS
Oxford and Groningen



Viviana ZELIZER
Princeton





YOUR SUPPORT

Our campaign aim is to raise €50M from corporation, foundations and individuals, in France and abroad. With that support we can deliver true global impact: your gift will make a real difference.

How?

You can either make a donation to the general TSE endowment fund, or support a specific project such as an impact centre, a research programme, a professorship, a scholarship or a conference.

Contact our campaign team

Send an email to: support@tse-fr.eu or contact Karine Arcache : +33 (0)5 61 12 85 33

Tax-efficient giving

► In the USA

American Friends of TSE, Inc. is a public charity exempt from Federal Tax under section 501 (c) (3), which enables US-based donors to benefit from full tax deductions.

► In Europe

Donors from an EU country wishing to making a gift to the TSE Foundation are eligible for tax benefits via the Transnational Giving Europe (TGE) network (<http://www.transnationalgiving.eu/>).

For more information, please contact us.

► In France

Any donation made to the TSE Foundation by a French tax resident (individuals and corporations) provides tax benefits to the donor.

• For individuals

66% of any individual donation is deductible on up to **20%** of taxable income. If the donation exceeds the limit, the excess is carried forward for 5 years under the same conditions (Article 200 / C.G.I.).

75% of your donation is deductible on wealth tax (ISF), up to €50,000 per year.

• For corporations

Your gift is deductible on corporate tax up to **60%** within the limit of **5%** of your company's turnover. If the donation exceeds the limit, the excess is carried forward for 5 years under the same conditions (Article 238bis / C.G.I.).



Toulouse
School
of Economics

Toulouse School of Economics

Manufacture des Tabacs
21 allée de Brienne
31015 TOULOUSE Cedex 6

www.tse-fr.eu