

THE TSE CAMPAIGN  
2016 - 2020

---

## **Toulouse Talent - Global Impact**

---





---

## **We owe our reputation to teamwork**

---

Jean TIROLE

TSE Chairman,  
Nobel Prize  
for Economics, 2014

# SUMMARY

- p.5 • Our vision
- p.7 • Our talents
- p.10 • Key figures
- p.12 • Our future
- p.16 • Our governors
- p.18 • Your support



**TSE experts  
created an amazing  
place for young  
researchers.**

Susan ATHEY  
Professor of Economics  
Stanford University



**TSE is one of the  
best departments  
in the world.**

Olivier BLANCHARD  
Peterson Institute, MIT  
& former IMF  
Chief Economist



**TSE is undoubtedly  
one of the foremost centers  
of research and teaching  
in the world today.**

Amartya SEN  
1998 Nobel Prize Laureate  
Harvard University



**TSE has become  
a world-class  
research and teaching  
institution.**

Eric MASKIN  
2007 Nobel Prize Laureate  
Harvard University



**Join us in taking  
TSE even further:  
be part of the Toulouse  
Talent - Global Impact  
campaign.**

Christian GOLLIER  
TSE Director



---

# **Economics can be a force for good in the world**

---

Jean-Jacques LAFFONT

TSE founder, 1947-2004





# OUR VISION

In 1979 Jean-Jacques Laffont, world-class economist, returned to his hometown Toulouse from the USA. Visionary and entrepreneurial as he was, his dream was to combine the best of his different worlds to create a new model in France: an internationally renowned school of economics within a public university.

As Jean-Jacques used to say, “*Toulouse, c’est mon Amérique à moi*”. And so he gathered around him a strong group of like-minded colleagues committed to academic excellence, all determined for economics to have a real impact on society and everyday lives.

These so-called “*économistes de Toulouse*” steadily laid the foundations for what, 30 years later, has become Toulouse School of Economics, a thriving world-renowned center for research in economics chaired by Nobel-prize laureate Jean Tirole.

## ***TSE strives to:***

- **provide solutions to today’s key economic and social issues**
- **promote excellence in research & higher education**
- **encourage pioneering interdisciplinary research**
- **connect research to policy, in France, Europe and worldwide**
- **implement highest international standards in its own governance**



# OUR TALENTS

## **A world-class research center in economics, connected to policy**

The award of the Nobel Prize in Economics to Jean Tirole in 2014 came as a great recognition for TSE's achievements in its relatively short lifetime. Many other accomplishments make us proud, including a record-breaking number of European Research Council grants, top publications, high rankings and impactful recruitments.

TSE has always fostered an academic environment that nurtures a diverse range of international talent and expertise. We pride ourselves on attracting the best and the brightest to Toulouse from leading US and European institutions.

While TSE's unique atmosphere is hard to define, there is a palpable sense of a "TSE-style economics". Based on a broad range of academic interests and a deep sense of curiosity, open mindedness and an engrained culture of collaborative work, our approach is coupled with an appetite for tackling real-world problems and generating deployable policy solutions.



**“ TSE is one of the very  
top economics faculties,  
incredibly strong in  
mechanism and  
market design. ”**

Preston MCAFEE  
Former Microsoft Chief Economist



**“ In Toulouse, theory  
is done in a way that's  
relevant to all questions  
in the world, and that's  
wonderful. ”**

Abhijit BANERJEE  
MIT Professor



## OUR TALENTS

### An international graduate program

Our competitive international higher education programs within the University of Toulouse pioneer a novel approach to higher education in France.

While the core focus is economics, our courses are multidisciplinary and concentrate on the role that data and quantitative techniques play in decision-making in firms, institutions or states.

Mathematical modelling helps develop rigorous reasoning in complex situations and statistical and quantitative methods help to assess the impact of strategy changes and policy reforms.

In sum, our research-oriented courses train our students to master and adapt recent theories and techniques to solve the real-world challenges of their future employers.



**“At TSE, students get the methodology and the tools to face a world that is getting more and more complex.”**

Alexia LEE GONZALEZ FANFALONE  
Former TSE PhD student



**“Several former TSE students have joined us and their analytical capabilities are a clear asset.”**

Fabrice BRÉGIER  
Former Airbus CEO





## OUR TALENTS

### A pioneering interdisciplinary institute

In 2011 we launched the **Institute for Advanced Study in Toulouse, IAST**. Innovation in approaches and methods is engrained in our culture, as is the quantitative / empirical mix. IAST is a powerful example of this innovation at work. The scientific program involves nine social and behavioral sciences : anthropology, biology, economics, history, law, philosophy, political science, psychology and sociology. This is a unified scientific project whose aim is to study the behavioral of human beings as evolved biological organisms who live in groups, form networks and coalitions, are governed by formal institutions and informal norms, produce and exchange scarce resources and are inspired by ideals and beliefs.

Over its five years of existence, the IAST has made the transition from being a wholly unknown start-up to being a credible research institute with a growing international reputation and a novel way of working.



**“ IAST has become a major international research center, bringing together a quite extraordinary array of scholars in the equally extraordinary setting of Toulouse. ”**

Ian MORRIS  
Professor of History, Stanford



**“ It is when we consider the deepest questions about human nature and society that we recognize the important role of IAST. ”**

Mahzarin R. BANAJI  
Professor of Psychology, Harvard

## KEY FIGURES & EXPERTISE



FINANCIAL  
REGULATION



CLIMATE  
CHANGE

**2<sup>nd</sup>**  
best research  
center in  
micro  
economics  
(RePEc)

**200**

public debate  
contributions  
per year

**2**

Laboratories of  
excellence

**350**

conferences and  
seminars  
per year

**180**

peer-reviewed  
articles published  
per year

**90**

nationalities

**40**

research  
partnerships



NETWORK INDUSTRY  
REGULATION



**Top 10**  
research center  
in economics in  
the world  
(RePEc)

\*9 ERC “starting” grants and  
9 ERC “advanced” grants &  
1 ERC “Consolidator” grant

**3<sup>rd</sup>**

beneficiary in  
Europe of EU  
support to economic  
excellence\*

**381**

international  
visiting scientists  
per year



PAYMENT  
SYSTEMS



COMPETITION  
LAW

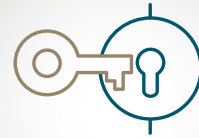

INTELLECTUAL  
PROPERTY

**2400**  
students

**100**

international  
academic PhD  
placements in  
5 years

**28**

years of connecting  
research to the  
corporate  
world

**135**

researchers

**30**

associate  
researchers



TWO-SIDED  
MARKETS



# OUR FUTURE

## Help us develop economic knowledge for a better world

Philanthropic support has played a significant role in the creation of TSE and in its development ever since.

In 2016, we launched our second fundraising campaign, “**Toulouse talent, global impact**”, with the aim of raising **€50M by 2020**. With this campaign, we want to strengthen TSE’s position as a leading research and teaching institution in economics, and to ensure that TSE’s people continue to provide solutions to today’s key economic and social issues. We also wish to sustain an innovative and multidisciplinary approach to science, building on the work done by IAST, TSE’s sister institution.

### **The money we raise helps support our three strategic priorities:**

**RESEARCH:** Solving key economic and social issues

**STUDENTS:** Educating the brightest future talent

**CAMPUS:** Offering an exciting location





## OUR FUTURE

### Solving key economic and social issues - €37M

Our researchers' work leads to a better understanding of the economic rules and mechanisms that govern the world we live in.

Innovation is part of our culture while being grounded in real-world issues. It's in TSE's DNA to contribute to public debate, to connect research and public policy, and to have researchers interact with firms. Moreover, while economics will always remain at the core of our activity, we firmly believe that fascinating and often unexpected synergies emerge from interdisciplinary approaches, which are increasingly recognized as the future for top-level academic endeavor.

To achieve our ambitious scientific goals and encourage the emergence of leading teams in priority research fields we want to secure existing posts; endow new ones; and create new research centers and visiting programs.

**For this purpose, we need your support.**

#### Invest in our endowment and ensure funding for:

- More global debate-fueled **research chairs and centers** (focused on priority research fields such as digital economy, climate change and energy, health, and sustainable and innovative finance, etc.)
- More **visiting professorships**
- More **interdisciplinary programs**
- More **research projects** on wide-reaching themes such as development and infrastructures, migration, religion, and population ageing, etc.



## OUR FUTURE

### **Educating the brightest future talent - €8M**

**Educating tomorrow's top economists is key to our future.** At TSE, we are proud to offer our students a competitive international higher education program within the University of Toulouse, and to pioneer a novel approach to higher education in France.

Our research-oriented courses train our students to master and adapt the best current theories and techniques to solve the real-world challenges that their future employers will face. We want to go further. We will provide a range of internationally competitive scholarships and postdoctoral fellowships within an overall educational package that meets the highest international standards and offers new opportunities for international mobility.

**With your support, we can bring exceptional students and young researchers from all over the world to benefit from the extraordinary resources at TSE and IAST.**

#### **Help us offer:**

- Undergraduate and graduate scholarships
- Postdoctoral fellowships
- Tailor-made career support services

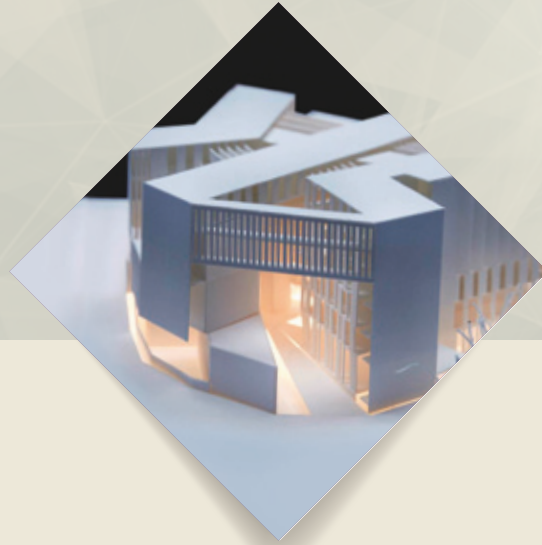

## OUR FUTURE

### Optimize our environment to foster innovation - €5M

A brand-new building will house TSE and IAST in 2019. Designed by internationally-renowned Irish architects Grafton, this purpose-built chef d'oeuvre is located in the historic center of Toulouse.

The funding for the basic structure is in place and we now seek the financial resources to fit out and equip it to the highest standards, providing faculty and students with an **exciting, cutting-edge place to work**, think and learn. This state-of-the-art building is designed to include facilities for hosting international conferences and seminars at the highest level: interaction is a core part of our mission.

High-visibility naming opportunities will be available in this new building, from amphitheaters to experimental laboratories

#### Provide our faculty and students with:

- **State-of-the-art facilities**
- Purpose-built behavioral experiment **laboratory**
- **Public outreach areas** mixing art, culture and science

# TSE SCIENTIFIC COUNCIL

Philippe AGHION  
Collège de France



Tim BESLEY  
LSE



Armin FALK  
University of Bonn



Luigi GUISO  
EIEF



Drew FUDENBERG  
MIT

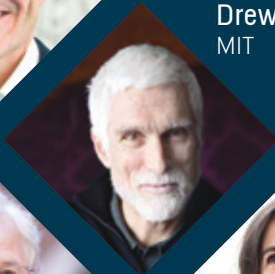

Costas MEGHIR  
Yale University



Rachel GRIFFITH  
University  
of Manchester



Bengt HOLMSTRÖM  
MIT



Roger MYERSON  
University of Chicago

Ariel PAKES  
Harvard



Eliana  
LA FERRARA  
Bocconi University



Jean-Marc ROBIN  
SciencesPo

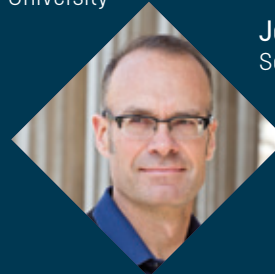

Rafael REPULLO  
CEMFI, Madrid



Guido TABELLINI  
Bocconi University



Tom SARGENT  
New-York University



Antoinette SHOAR  
MIT



# IAST SCIENTIFIC COUNCIL

**Mahzarin BANAJI**  
Harvard University

**Rob BOYD**  
Arizona State University

**Brandice CANES-WRONE**  
Princeton University



**Marion FOURCADE**  
Berkeley University



**Dora COSTA**  
UCLA



**Elizabeth GERBER**  
University of Michigan



**Gerard HERTIG**  
ETH Zurich

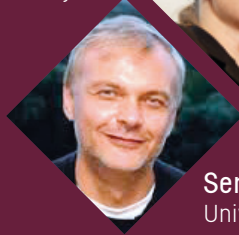

**Sergey GAVRILETS**  
University of Tennessee



**Cecilia HEYES**  
Oxford



**Louis KAPLOW**  
Harvard Law School

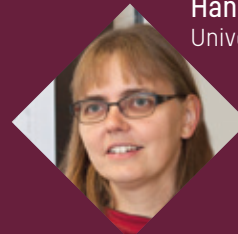

**Hanna KOKKO**  
University of Zurich



**Rachel E. KRANTON**  
Duke University



**Joel MOKYR**  
Northwestern

**Benoit MONIN**  
Stanford University



**Ian MORRIS**  
Stanford University



**Muriel NIEDERLE**  
Stanford University



**David PAPINEAU**  
Kings College London



**Thomas ROMER**  
Princeton

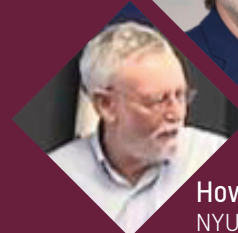

**Howard ROSENTHAL**  
NYU



**Drazen PRELEC**  
MIT



**Lawrence ROTHENBERG**  
University of Rochester



**Alan SCHWARTZ**  
Yale Law School



**Tom SNIJDERS**  
Oxford and Groningen



**Viviana ZELIZER**  
Princeton



# YOUR SUPPORT

TSE has reached about 75% of its campaign goal so far, with nearly 38M€ raised. We still need your help to reach our goal of raising €50 million by 2020.

Our donor community includes **corporations, individuals (Alumni, governors, staff, students, parents and friends) and charitable organizations** from France and worldwide.

By making a gift and helping us to raise awareness about our campaign, everyone has a chance to help us maintain our reputation of excellence and deliver true global impact.

## Ways to give

You can:

- **Make a major endowed gift** to support TSE and IAST over the long term: endowed gifts create permanent funds where the principal of the gift is invested to generate earnings that strengthen our institution for generations to come.
- **Make a planned gift** to provide future support to TSE and IAST: planned gifts include bequests and life income gifts.
- **Make a current-use gift** that has an immediate impact: the funds you donate are available to be spent right away to benefit students, faculty, and programs.

Whatever your preferred way to give, you can either support general research and training at TSE and IAST, or select a specific area or program to benefit from your generosity.

***Thank you for your support!***



## Tax-efficient giving

### ► *Giving from France*

Any donation made to the TSE Foundation by a French tax resident (individuals and corporations) provides tax benefits to the donor.

**For individuals:** 66% of any individual donation is deductible on up to 20% of taxable income. If the donation exceeds the limit, the excess is carried forward for 5 years under the same conditions (Article 200 C.G.I.). 75% of your donation is deductible on wealth tax (IFI), up to € 50,000 per year.

**For corporations:** Your gift is deductible on corporate tax up to 60% within the limit of 0,5% of your company's turnover. If the donation exceeds the limit, the excess is carried forward for 5 years under the same conditions (Article 238bis C.G.I.).

### ► *Giving from Europe*

Corporate and individual donors from a European country wishing to make a gift to TSE or IAST are eligible for tax benefits via the Transnational Giving Europe (TGE) network.

### ► *Giving from the USA*

American Friends of TSE, Inc. is a public charity exempt from Federal Tax under section 501 (c) (3), which enables US-based donors to benefit from full tax deductions. For more information, visit our AF/TSE section: [www.tse-fr.eu/aftse](http://www.tse-fr.eu/aftse)

[www.tse-fr.eu/campaign](http://www.tse-fr.eu/campaign)

If you would like to discuss your support for TSE or IAST, please contact our team; we can help to match your generous philanthropy with our priorities.

Eve Séjalon: +33 (0)684 747 828 - [campaign@tse-fr.eu](mailto:campaign@tse-fr.eu)



**Toulouse School of Economics**

Manufacture des Tabacs  
21 allée de Brienne  
31015 TOULOUSE Cedex 6

[www.tse-fr.eu](http://www.tse-fr.eu)